

Power TVS in DO-218AB

Features

- Glass passivated chip
- 3600W peak pulse power(10/1000us)
- High accuracy, 5% tolerance
- Uni and Bidirectional unit
- Low clamping voltage
- Low Leakage current
- Very fast response time
- AEC-Q101 qualified

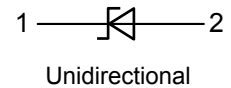
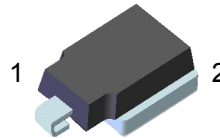

Mechanical Data

- **Case:** DO-218AB(plastic package).
RoHS compliant
- **Molding Compound Flammability Rating:**
UL 94 V-0
- **Terminals:** High temperature soldering guaranteed:
260 °C/10 sec. at terminals

Applications

- Use in sensitive electronics protection against voltage transients induced by inductive load switching and lighting, especially for automotive load dump protection application.

Absolute Maximum Ratings

Ratings at 25 °C, ambient temperature unless otherwise specified

Parameter	Symbol	Value	Unit
Peak pulse power dissipation with a 10/1000us waveform ⁽¹⁾	P _{PP}	3600	W
Maximum peak reverse pulse current a 10/1000us waveform ⁽¹⁾	I _{PP}	See Next Table	A
Peak forward surge current 8.3ms single half sine-wave ⁽²⁾	I _{FSM}	100	A
Operating junction and storage temperature range	T _J , T _{STG}	-55 to +150	°C

Notes:

- 1.Non-repetitive current pulse,per Fig.5 and detated above TA=25°C per Fig.1
- 2.Measured on 8.3ms single half sine-wave,or equivalent square wave,duty cycle=4 pulses per minute maximum

Electrical Characteristics

 (T_A = 25 °C unless otherwise specified)

Part Number		Reverse Stand off Voltage VR (V)	Breakdown Voltage VBR (V) @ IT		Test Current IT (mA)	Maximum Clamping Voltage VC @ IPP (V)	Maximum Peak Pulse Current IPP (A)	Maximum Reverse Leakage IR @ VR (μA)
UNI	BI		MIN	MAX				
SM5S15A	SM5S15CA	15	16.7	19.2	1	24.4	148	10
SM5S16A	SM5S16CA	16	17.8	20.5	1	26.0	138	10
SM5S17A	SM5S17CA	17	18.9	21.7	1	27.6	130	10
SM5S18A	SM5S18CA	18	20	23.3	1	29.2	123	10
SM5S20A	SM5S20CA	20	22.2	25.5	1	32.4	111	10
SM5S22A	SM5S22CA	22	24.4	28.0	1	35.5	101	10
SM5S24A	SM5S24CA	24	26.7	30.7	1	38.9	93	10
SM5S26A	SM5S26CA	26	28.9	33.2	1	42.1	86	10
SM5S28A	SM5S28CA	28	31.1	35.8	1	45.4	79	10
SM5S30A	SM5S30CA	30	33.3	38.3	1	48.4	74	10
SM5S33A	SM5S33CA	33	36.7	42.2	1	53.3	68	10
SM5S36A	SM5S36CA	36	40	46.0	1	58.1	62	10
SM5S40A	SM5S40CA	40	44.4	51.1	1	64.5	56	10
SM5S43A	SM5S43CA	43	47.8	54.9	1	69.4	51	10
SM5S45A	SM5S45CA	45	50	57.5	1	72.2	49	10
SM5S48A	SM5S48CA	48	53.3	61.3	1	77.4	46	10
SM5S51A	SM5S51CA	51	56.7	65.2	1	82.4	43	10
SM5S54A	SM5S54CA	54	60	69	1	87.1	41	10

Typical Characteristics ($T_{amb} = 25\text{ }^{\circ}\text{C}$ unless otherwise specified)

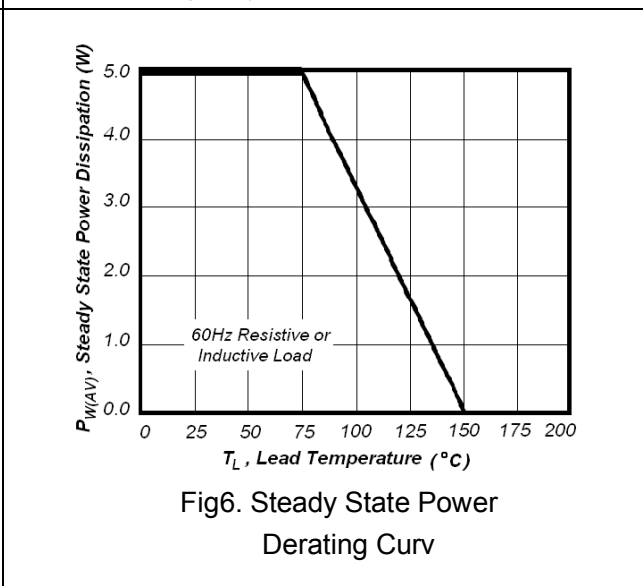
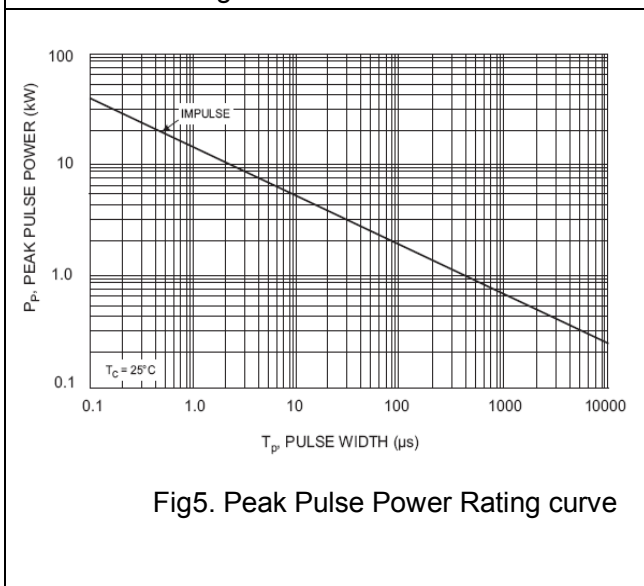
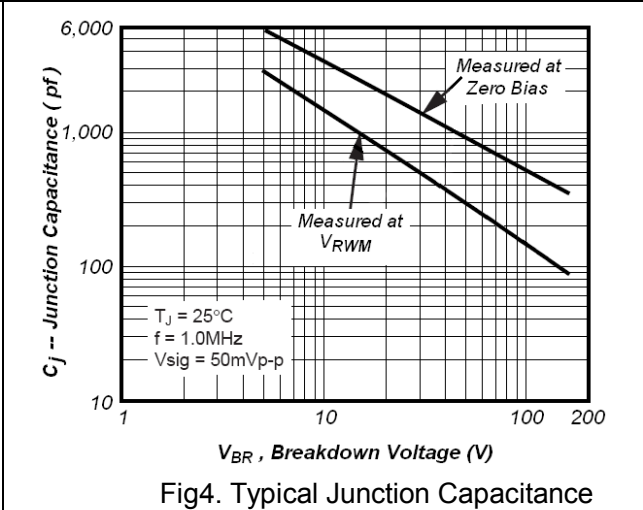
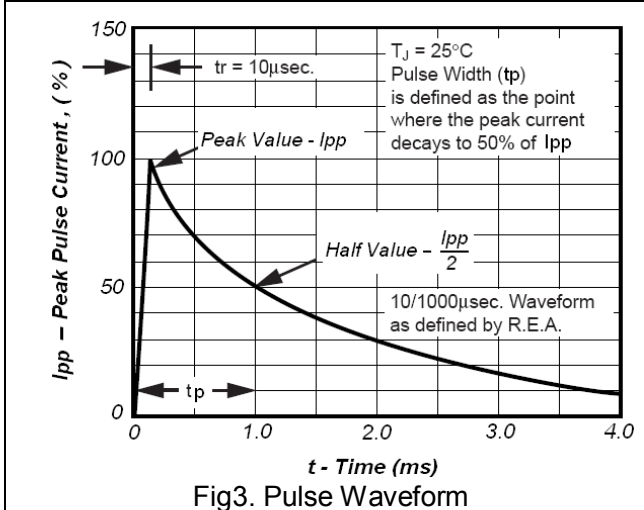
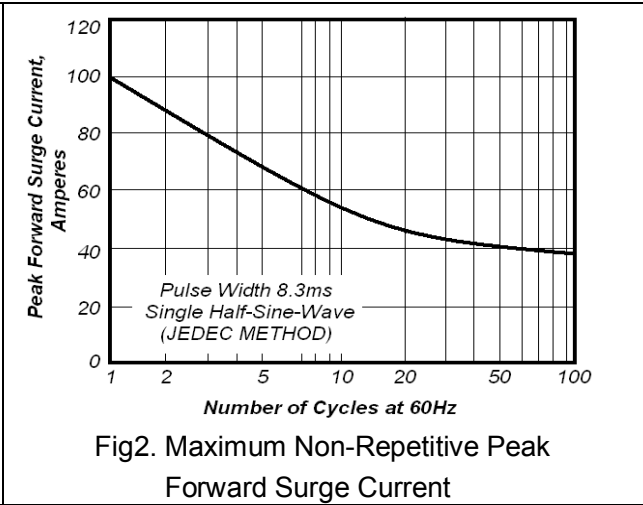
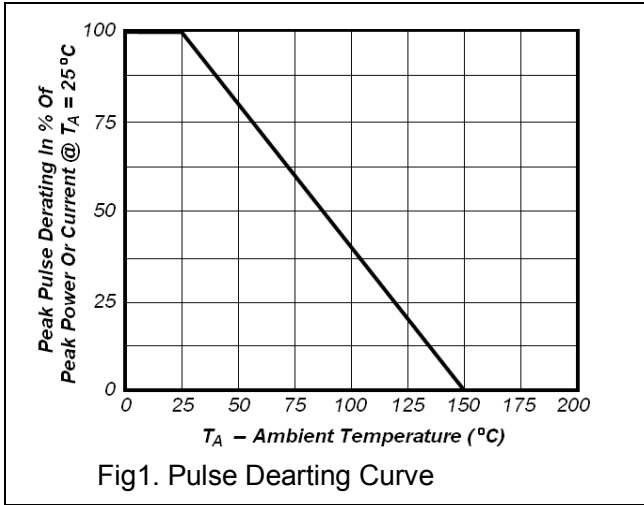

Package Dimensions

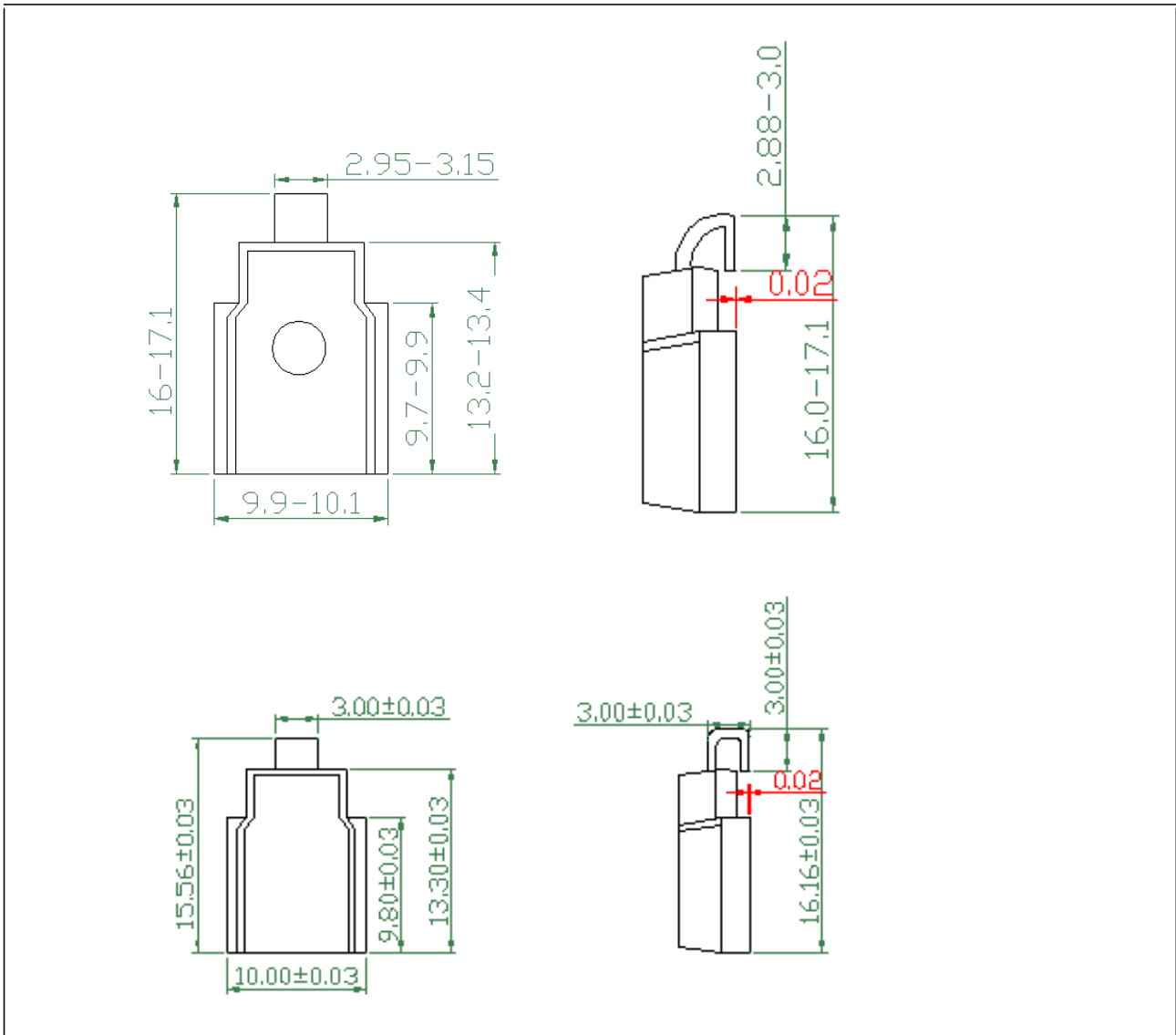

Ordering information

Order code	Package	Packaging option	Base quantity	Packaging specification
SM5S Series	DO-218AB	Tape and reel	750pcs / reel	EIA STD RS-481

Revision history

Date	Revision	Changes
23-May-2020	1.0	Initial release

CAUTION / WARNING

Information in this document is believed to be accurate and reliable. However, RDSEMI does not give any representations or warranties, expressed or implied, as to the accuracy or completeness of such information and shall have no liability for the consequences of use of such information.

Users should independently evaluate the suitability of and test each product selected for their own applications, and RDSEMI assumes no liability what's ever relating to the choice, selection or use of the RDSEMI products and services described herein.

RDSEMI reserves the right to change or update, without notice, any information contained in this publication; to change, without notice, the design, construction, processing, or specification of any product; and to discontinue or limit production or distribution of any product.

Information in this document supersedes and replaces all information previously supplied.

Products are not designed, authorized or warranted to be suitable for use in medical, military, aircraft, space or life support equipment, nor in applications where failure or malfunction of an RDSEMI product can reasonably be expected to result in personal injury, death or severe property or environmental damage. RDSEMI accepts no liability for inclusion and/or use of RDSEMI products in such equipment or applications and therefore such inclusion and/or use is at the customer's own risk.

This document as well as the item(s) described herein may be subject to export control regulations. Export might require a prior authorization from national authorities.

Resale of RDSEMI products with provisions different from the statements and/or technical features set forth in this document shall immediately void any warranty granted by RDSEMI for the RDSEMI product or service described herein and shall not create or extend in any manner whatsoever, any liability of RDSEMI.

RDSEMI expressly disclaims all implied warranties regarding the information contained herein, including, but not limited to, any implied warranties of merchantability or fitness for a particular purpose. RDSEMI only obligations are those in the RDSEMI Standard Terms and Conditions of Sale and in no case will RDSEMI be liable for any incidental, indirect, or consequential damages arising from the sale, resale, use, or misuse of its products.

Specifications are subject to change without notice
© Copyright 2020, DaJing Semiconductor
All rights reserved